



---

# **Proposed George T. Harrell, M.D. Medical Education Building**

*December 13, 2012*

# Medical Curriculum

- 1956:** College of Medicine founded
- 1970:** Curriculum #2
- 1980s:** Curriculum #3
- 1990s:** Evolutionary Change
- 2012:** Curriculum #4

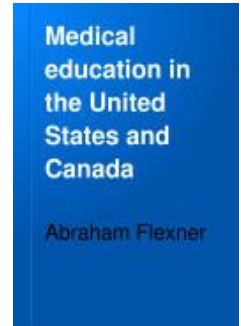

Flexner Report  
1910

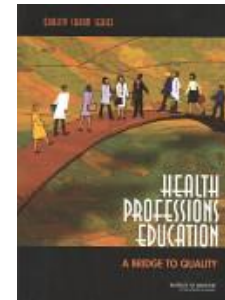

Institute of Medicine  
2003

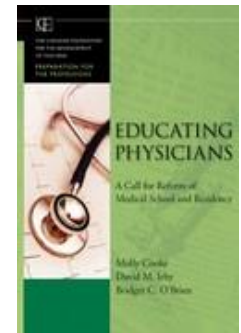

Carnegie Foundation  
2010

## UF Curriculum Review

Began July 2010: COM Faculty, Students, Health Science College members

Three Retreats

Needs Analysis Group

Curriculum Design Group

Multiple Refinements

Implement: August 2012

# New Curriculum Themes

- ❏ Patient centered; organized by organ system rather than discipline
- ❏ Active, collaborative, team-based
- ❏ Communication
- ❏ Experiential learning and assessment
- ❏ New and expanded topics
- ❏ Enhanced preparation for residency
- ❏ Scholarship
- ❏ Flexibility



# University of Florida Medical Curriculum 2010-11

First Year				
<p>Integrated Instruction in: Clinical Human Anatomy, <b>Anatomy</b> by Diagnostic Imaging, and Medical Cell and Tissue Biology (16 weeks)</p>	<p>Introduction to Clinical Preceptorship (AHEC) (3 weeks)</p>	<p>Medical <b>Neuroscience</b> (5 weeks)</p>	<p><b>Principles of Physiology</b> (17 weeks)</p>	
			<p><b>Biochemistry</b> and Molecular Biology of Disease (12 weeks)</p>	<p>Aspects of Medical Genetics (5 weeks)</p>
			<p>Human Behavior (17 weeks)</p>	
<p>Essentials of Patient Care 1 (16 weeks)</p>			<p>Essentials of Patient Care 2 (16 weeks)</p>	
<p>Interdisciplinary Family Health 1 (16 weeks; only 6 classroom meetings)</p>			<p>Interdisciplinary Family Health 2 (16 weeks; only 6 classroom meetings)</p>	

Second Year			
<p>General <b>Pathology</b> and Immunology (8 weeks)</p>	<p>Integrated Instruction in: Systemic Pathology and Laboratory Medicine, Oncology, and Introduction to Clinical Radiology (17 weeks)</p>		<p>Medical <b>Pharmacology</b> (11 Weeks)</p>
<p><b>Medical Microbiology</b> and Infectious Disease (15 weeks)</p>		<p>Evidence Based Medicine (15 weeks)</p>	
<p>Ethical &amp; Legal Issues in Medical Practice (17 weeks)</p>		<p>Clinical Diagnosis (18 weeks)</p>	
<p>Essentials of Patient Care 3 (19 weeks)</p>	<p>Essentials of Patient Care 4 (15 weeks)</p>		

<b>Intro to Clinical Medicine:</b> communication, information gather, Hx & PE, organize, assess (EBM) - stats		<b>Health Policy</b>	<b>Hx &amp; PE + anatomy, organize, assess (EBM) - stats study designs</b>		<b>Preceptorship</b>	<b>Holiday</b>	<b>Intro to Clinical Medicine</b>		<b>vacation</b>	<b>Intro to Clinical Medicine</b>		<b>Health Policy</b>	<b>Intro to Clinical Medicine</b>		<b>Preceptorship</b>	<b>Discovery/ research/ other</b>
<b>Genes and Health</b>	<b>Foundations of Medicine: Intro to structure function of body</b>		<b>Foundations of Med: (e.g. pharm., general path., population health)</b>				<b>Inf Disease and Immunol</b>	<b>Oncology</b>		<b>CV-Pulmonary</b>	<b>Renal</b>					
<b>Discovery pathway/scholarship</b>																
<b>The Profession of Medicine: becoming a physician</b>																
<b>Patient safety/Health Outcomes</b>																
<b>Health Policy/ Patient Advocacy</b>																
<b>Practice based learning: EBM/Informatin literacy</b>																
<b>Systems Based Practice- Collaborative &amp; interprofessional care</b>																

<b>Discovery</b>	<b>Intro to Clin Medicin</b>		<b>Interession</b>	<b>Intro to Clin Med</b>		<b>Preceptorship</b>	<b>Intro to Clinical Med</b>					<b>OSCE</b>	<b>USMLE Step 1: Vacation</b>	<b>Orientation</b>	<b>Clinical: required clerkships</b>			<b>Interession</b>	<b>Vacation</b>
	<b>Neuro</b>	<b>GI</b>		<b>Musct loskel etal</b>	<b>Derm</b>		<b>Holiday</b>	<b>Hematolo gy</b>	<b>Endocrinol Reproduct</b>	<b>clinical: required clerkships</b>									
<b>Discovery pathway/scholarship</b>																			
<b>The Profession of Medicine: becoming a physician</b>																			
<b>Patient safety/Health Outcomes</b>																			
<b>Health Policy/ Patient Advocacy</b>																			
<b>Practice based learning: EBM/Informatin literacy</b>																			
<b>Systems Based Practice- Collaborative &amp; interprofessional care</b>																			

<b>clinical: required/elective/selective</b>		<b>Interession 5:OSCE</b>	<b>clinical: required/ elective/ selective</b>		<b>Interession</b>	<b>Holiday</b>	<b>clinical : required/elective/selective</b>			<b>Interession</b>	<b>clinical: required/ elective/ selective</b>		<b>OSCE</b>	<b>clinical: required/ elective/ selective</b>		<b>Vacation</b>
<b>clinical: required/elective/selective</b>			<b>clinical: required/ elective/ selective</b>				<b>clinical : required/elective/selective</b>				<b>clinical: required/ elective/ selective</b>			<b>clinical: required/ elective/ selective</b>		
<b>Discovery pathway/scholarship</b>																
<b>The Profession of Medicine: becoming a physician</b>																
<b>Patient safety/Health Outcomes</b>																
<b>Health Policy/ Patient Advocacy</b>																
<b>Practice based learning: EBM/Informatin literacy</b>																
<b>Systems Based Practice- Collaborative &amp; interprofessional care</b>																

<b>clinical: required/elective/ selective</b>		<b>Interession</b>	<b>clinical/ elective/ selective</b>		<b>interview/ step 2/ vacation/ electives</b>		<b>Holiday</b>	<b>Interview/ Step 2/ electives</b>		<b>clinical/ elective/ selective</b>		<b>Internship 101-</b>	
<b>clinical: required/elective/ selective</b>			<b>clinical/ elective/ selective</b>		<b>interview/ step 2/ vacation/ electives</b>			<b>Interview/ Step 2/ electives</b>		<b>clinical/ elective/ selective</b>		<b>Internship 101-</b>	
<b>Discovery pathway/scholarship</b>													
<b>The Profession of Medicine: becoming a physician</b>													
<b>Patient safety/health Outcomes</b>													
<b>Health Policy/ Patient Advocacy</b>													
<b>Practice based learning: EBM/Informatin literacy</b>													
<b>Systems Based Practice- Collaborative &amp; interprofessional care</b>													

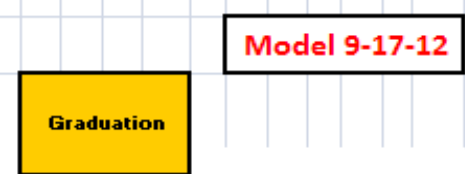

# Form Follows Function

- Learning studios
- Small group and collaborative learning space
- Independent learning spaces
- Simulation, clinical skills and assessment
- Community student space
- Student and curriculum support services
- Physician Assistants Program



# Current Facilities



# Current Facilities





Shands at University of Florida



World • United States • FL • Alachua Co. • Gainesville

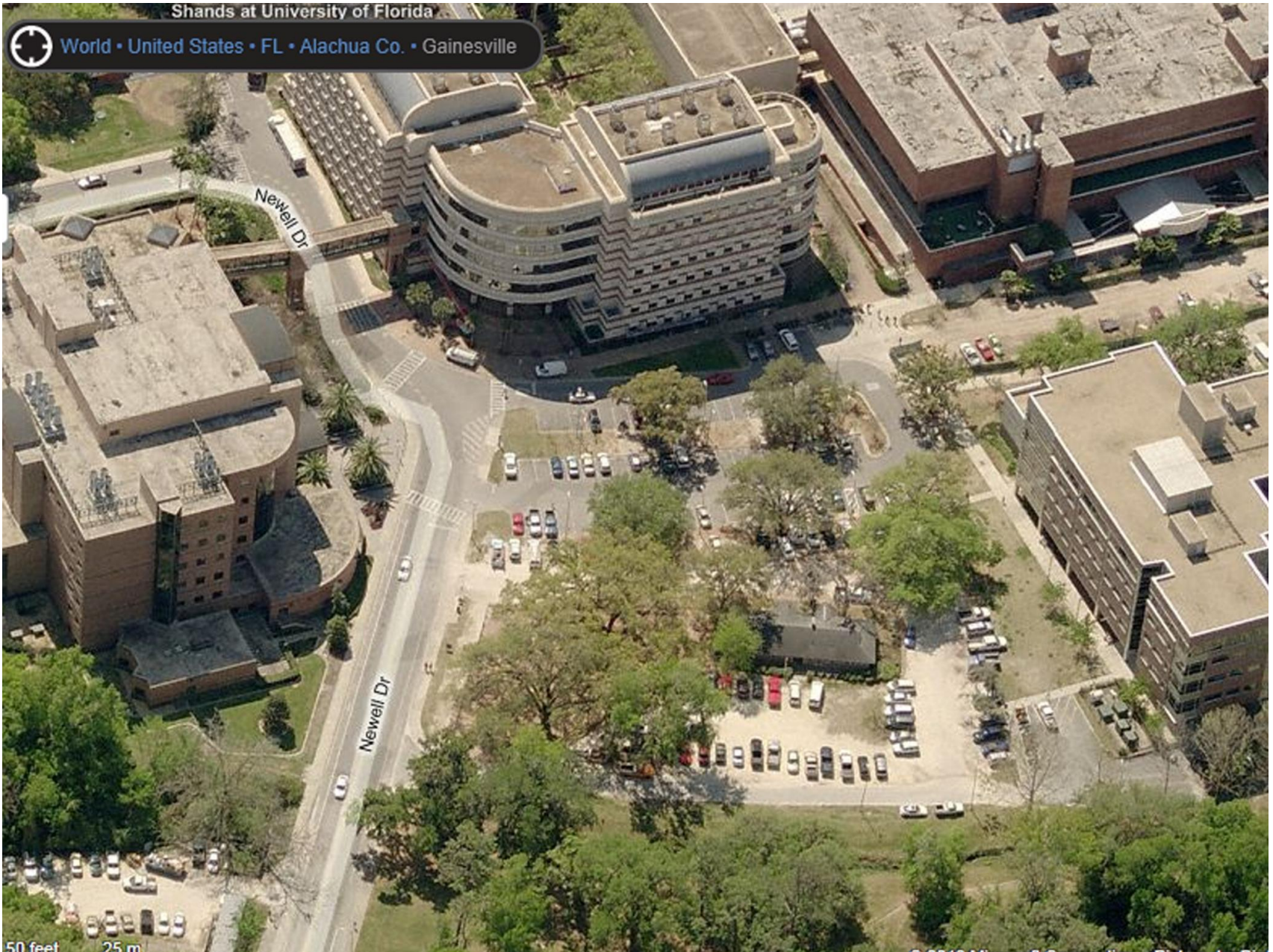

# 1st Floor



LARGE LEARNING STUDIO

BUILDING SERVICE / CORE

LARGE LEARNING STUDIO

COMMONS

# Learning Studio



# Commons



# 2<sup>nd</sup> Floor

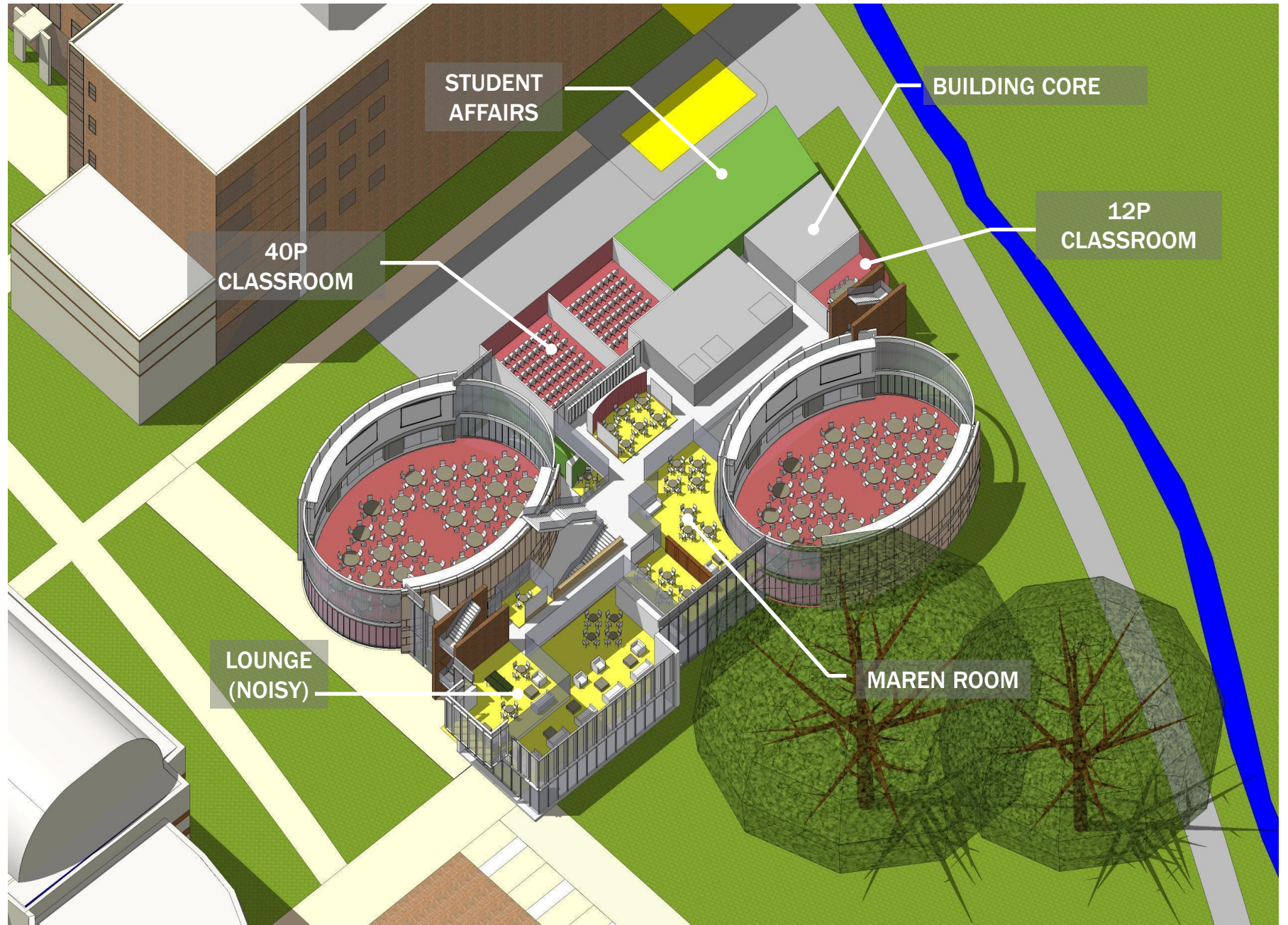

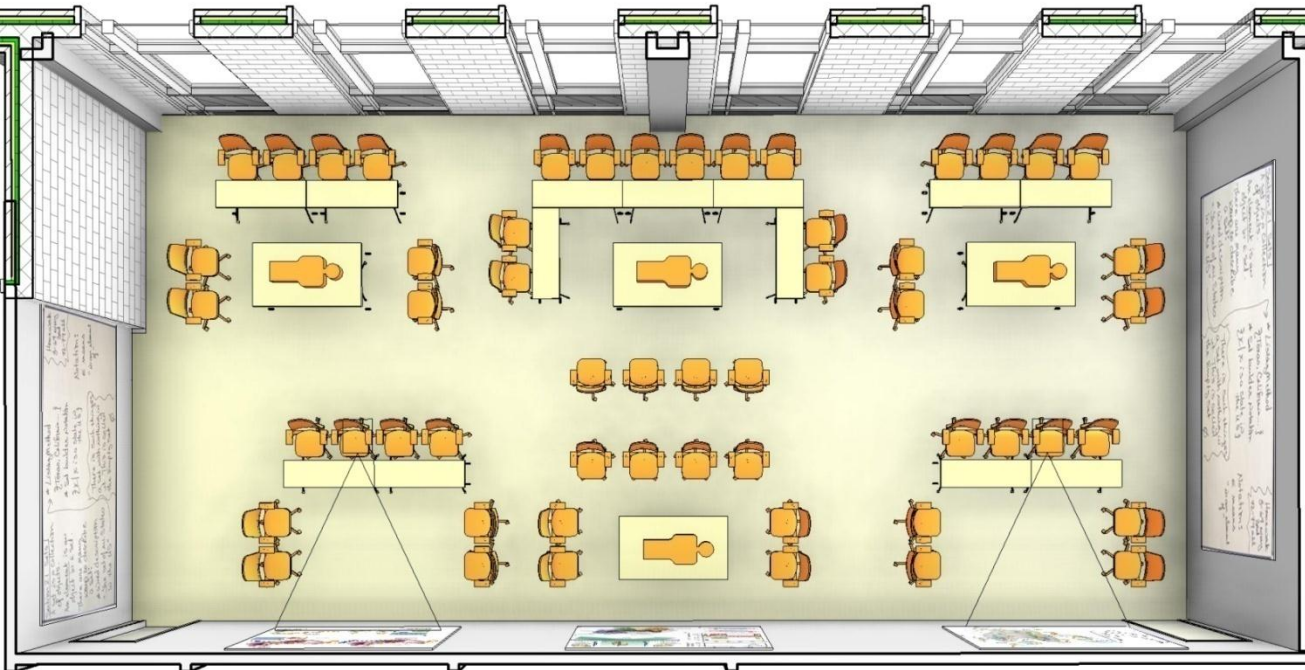
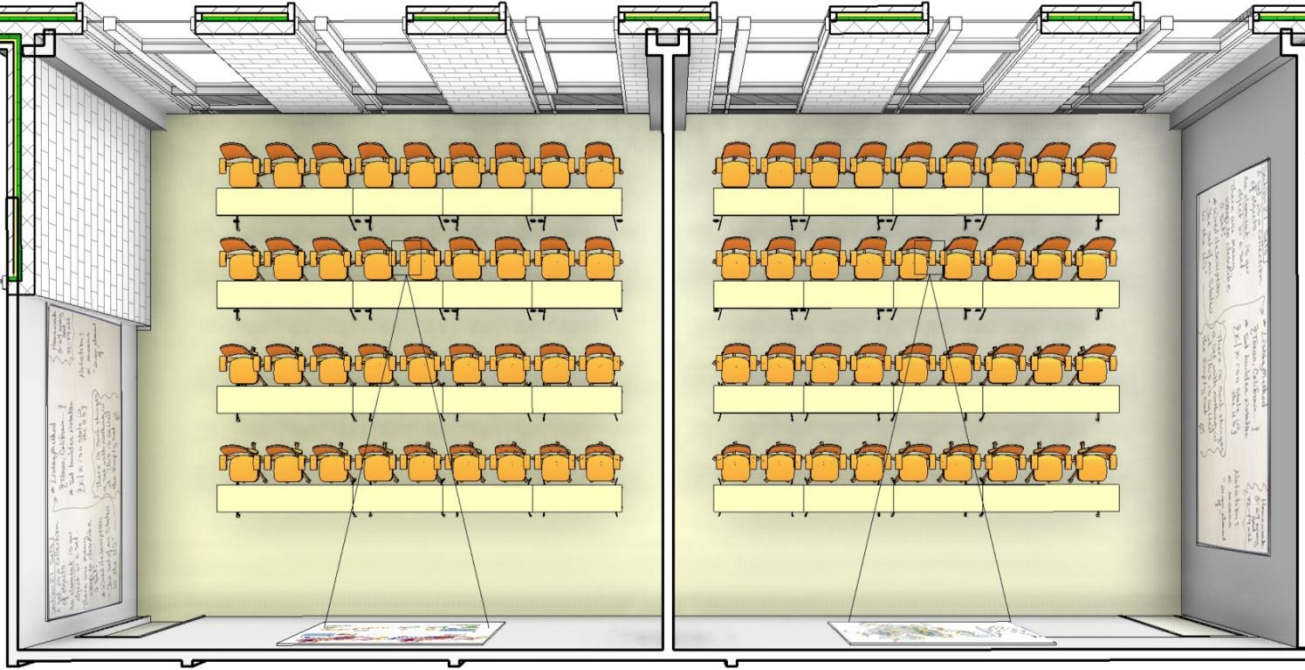

# 3<sup>rd</sup> Floor

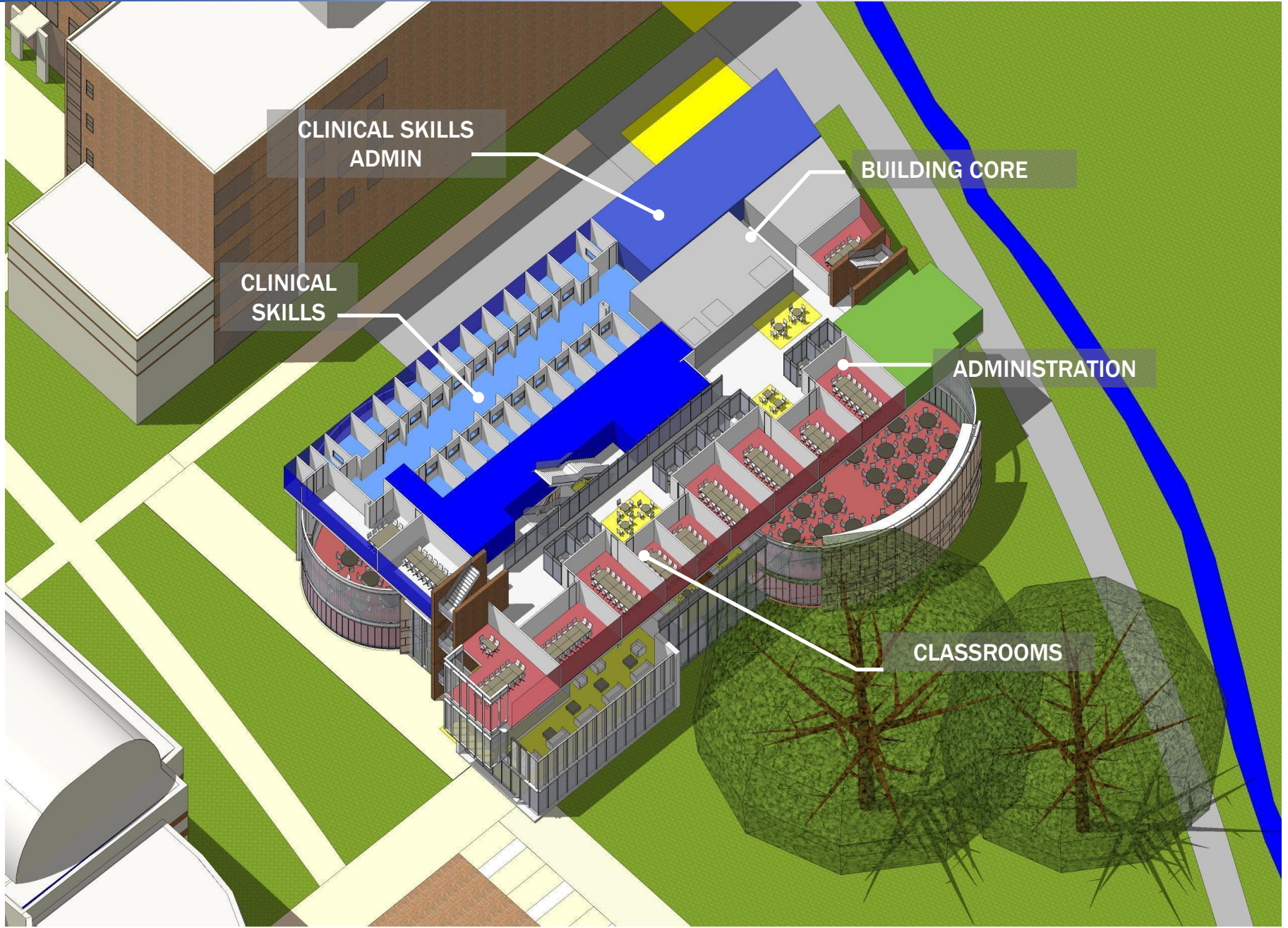

# Clinical Skills Center

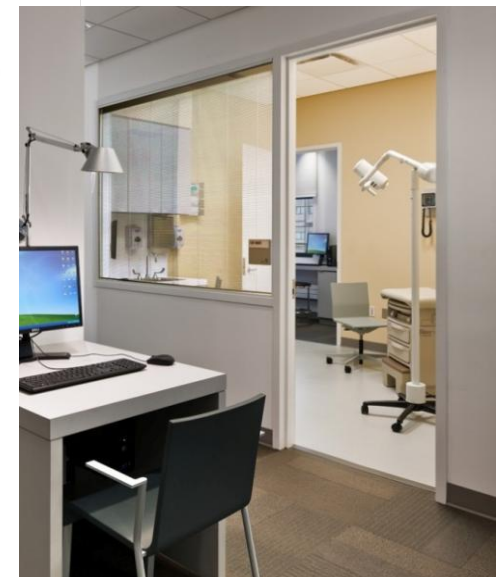
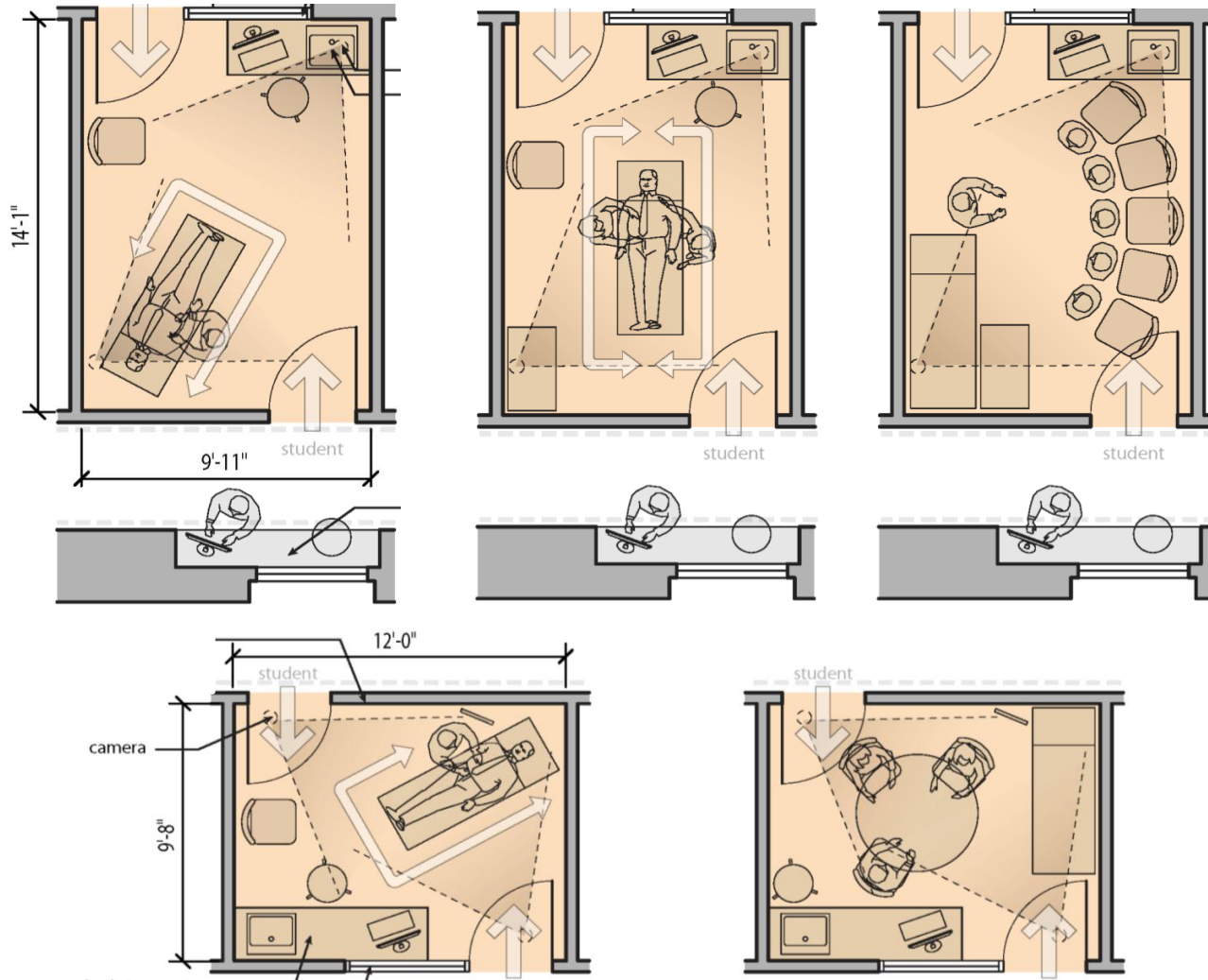

Clinical Skills: Patient Exam Rooms



# 4<sup>th</sup> Floor

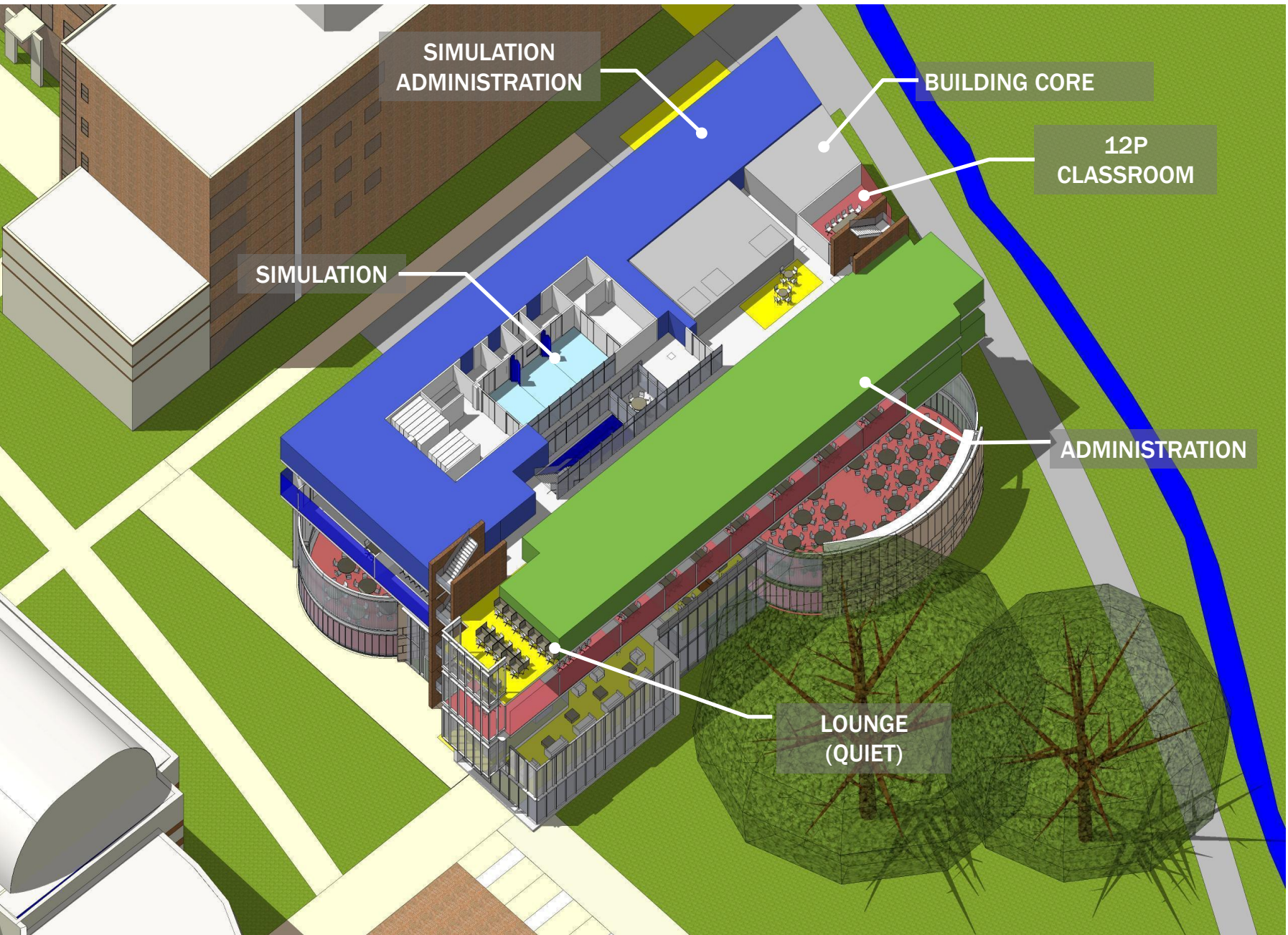

SIMULATION  
ADMINISTRATION

BUILDING CORE

12P  
CLASSROOM

SIMULATION

ADMINISTRATION

LOUNGE  
(QUIET)

# Simulation Theater



# Simulation Theater











